

CABLE PROTECTION SYSTEMS

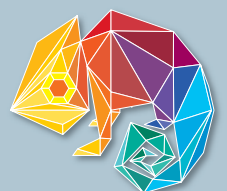

CONDUITS & FITTINGS



Reliable protection for cables

In industry, cables and wires are exposed to exceptional loads. Heat and cold, tensile and compressive loads, and wear-and-tear cause damage to cables and can result in malfunctions and loss of production. HUMMEL AG cable protection conduits provide reliable protection. Like a chameleon, the cable protection range is extremely versatile.

The Polyamide range and the galvanised steel protective tubing of the metal range offer suitable solutions for every application. A wide range of fittings makes it easy for planners and designers to find the right answer for every requirement.

Polyamide

- // **Polyamide-Conduit** – the flexible polyamide cable conduit
- // **Polyamide-Fitting** – cable conduit for Polyamide-Conduit, made of galvanised steel

Metal

- // **Metal-Conduit** – multi-layer variants for heavy loads
- // **Metal-Fitting** – fittings for Metal-Conduits, designed for every type of installation
- // **Metal-Conduit Pro** – ideal for metal protective conduits
- // **Metal-Fitting Pro** – fittings for Metal-Conduit Pro, for exceptionally robust usage



Polyamide-Conduit

► 4

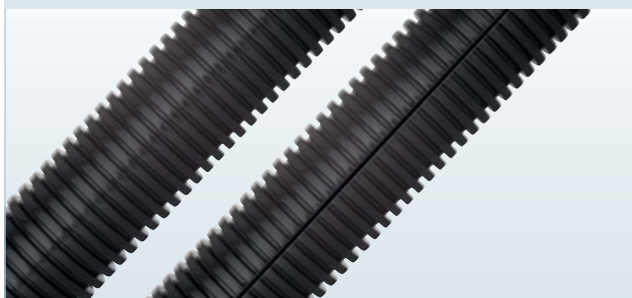

Polyamide cable conduits are characterised by their particularly high degree of flexibility. Whether in the standard or slit version, even extreme dynamic applications are no problem for Polyamide-Conduits. The large number of matching fittings and accessories provide solutions for all conceivable installation situations.

Metal-Conduit / Metal-Fitting

► 20



The Metal range of protective cable conduits are particularly resistant to mechanical stresses. The conduit types made of galvanized steel are able to withstand high pressure loads. Matching metal fittings complete the range, ensuring, that the system is 100 % industrial grade.

Polyamide-Fitting

► 6



A large selection of fittings and matching accessories round off the Polyamide-Conduit series into a well engineered concept. Thereby planners and installers are up to all assembly situations. With this professional protection improvised single solutions are things of the past.

Metal-Conduit Pro / Metal-Fitting Pro

► 24

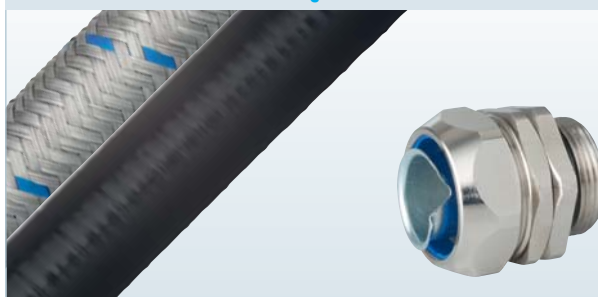

Metal-Conduit Pro offers a safe protection against heat and cold, intense mechanical loads and abrasion. The conduits are designed as multi-layer variants. They are available with PVC-Coating or exterior metal braiding. Fittings of the Metal-Fitting Pro series provide a perfect match for all Metal-Conduits of Serie Pro.

RoHS

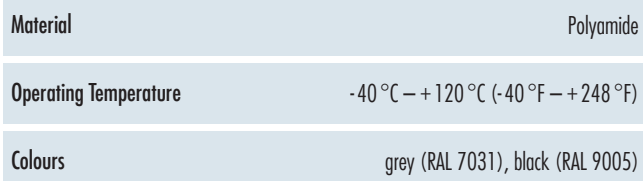

POLYAMIDE CABLE CONDUIT

Polyamide-Conduit Slit



| | |
|-----------------------|-------------------------------------|
| Material | Polyamide |
| Operating Temperature | -40 °C – +120 °C (-40 °F – +248 °F) |
| Colours | grey (RAL 7031), black (RAL 9005) |

RoHS

// raw material according to UL 94

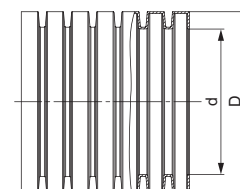

| Size DN | d mm | D mm | R mm | Number grey | Number black |
|------------|---------|---------|---------|----------------|-----------------|
| 6 | 6,5 | 10 | 15 | 1.527.0600.00 | 1.527.0601.00 |
| 10 | 10 | 13 | 25 | 1.527.0900.00 | 1.527.0901.00 |
| 12 | 12 | 15,8 | 35 | 1.527.1100.00 | 1.527.1101.00 |
| 14 | 14,2 | 18,4 | 35 | 1.527.1300.00 | 1.527.1301.00 |
| 17 | 16,5 | 21,2 | 40 | 1.527.1600.00 | 1.527.1601.00 |
| 23 | 23 | 28,4 | 45 | 1.527.2100.00 | 1.527.2101.00 |
| 29 | 29 | 34,5 | 55 | 1.527.2900.00 | 1.527.2901.00 |
| 37 | 36 | 42,5 | 65 | 1.527.3600.00 | 1.527.3601.00 |
| 50 | 48 | 54,5 | 80 | 1.527.4800.00 | 1.527.4801.00 |

Polyamide-Cut



| | |
|----------|---|
| Material | Housing made of plastic / metal, antiskid rubber handle |
| Colour | red |

// Tool for easy, exact and safe cutting of Polyamide-Conduits

| Cutting range | fits to DN | Number |
|---------------|---------------|---------------|
| 0 – 26 mm | 0 – 17 | 1.503.2600.00 |
| 0 – 63 mm | 0 – 50 | 1.503.6300.00 |

Polyamide-Fitting



| | |
|-----------------------|------------------------------------|
| Material | Polyamide |
| Protection category | IP 55 |
| Operating Temperature | -30 °C – +80 °C (-22 °F – +176 °F) |
| Colours | grey (RAL 7031), black (RAL 9005) |

RoHS

- // raw material according to UL 94
- // locknut optional
- // easy disassembly without tools

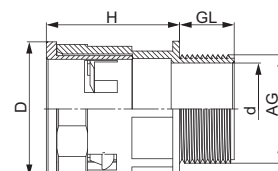

| AG | d mm | D mm | GL mm | H mm |  mm | fits to Polyamide- Conduit DN | Number grey | Number black |
|---------|---------|---------|----------|---------|--|----------------------------------|----------------|-----------------|
| M 12 | 6,9 | 18,7 | 11 | 26 | 15 | 6 | 1.533.1200.50 | 1.533.1201.50 |
| M 16 | 10,8 | 21,7 | 11 | 26 | 18 | 10 | 1.533.1600.51 | 1.533.1601.51 |
| M 16 | 10,9 | 26 | 11 | 26,5 | 20 | 12 | 1.533.1600.50 | 1.533.1601.50 |
| M 20 | 14,7 | 28 | 11 | 31 | 23 | 14 | 1.533.2000.51 | 1.533.2001.51 |
| M 20 | 15,2 | 32 | 13 | 33 | 27 | 17 | 1.533.2000.50 | 1.533.2001.50 |
| M 25 | 18,7 | 39,5 | 16 | 39 | 34 | 23 | 1.533.2500.50 | 1.533.2501.50 |
| M 32 | 25,7 | 46,5 | 16 | 43 | 40 | 29 | 1.533.3200.50 | 1.533.3201.50 |
| M 40 | 32,7 | 55,5 | 16 | 45,5 | 50 | 37 | 1.533.4000.50 | 1.533.4001.50 |
| M 50 | 51,4 | 67,5 | 16 | 47,5 | 62 | 50 | 1.533.5000.50 | 1.533.5001.50 |
| | | | | | | | | |
| PG 7 | 6,9 | 18,7 | 11 | 26 | 15 | 6 | 1.533.0700.14 | 1.533.0701.14 |
| PG 9 | 10,3 | 21,7 | 11 | 26 | 18 | 10 | 1.533.0900.14 | 1.533.0901.14 |
| PG 11 | 13,3 | 26 | 11 | 26,5 | 20 | 12 | 1.533.1100.14 | 1.533.1101.14 |
| PG 13,5 | 15,3 | 28 | 11 | 31 | 23 | 14 | 1.533.1300.14 | 1.533.1301.14 |
| PG 16 | 16,6 | 32 | 13 | 33 | 27 | 17 | 1.533.1600.14 | 1.533.1601.14 |
| PG 21 | 22,3 | 39,5 | 16 | 39 | 34 | 23 | 1.533.2100.14 | 1.533.2101.14 |
| PG 29 | 31,7 | 46,5 | 16 | 43 | 40 | 29 | 1.533.2900.14 | 1.533.2901.14 |
| PG 36 | 40,5 | 55,5 | 16 | 45,5 | 50 | 37 | 1.533.3600.14 | 1.533.3601.14 |
| PG 48 | 51,7 | 67,5 | 16 | 47,5 | 62 | 50 | 1.533.4800.14 | 1.533.4801.14 |



| | |
|-----------------------|------------------------------------|
| Material | Polyamide |
| Protection category | IP 55 |
| Operating Temperature | -30 °C – +80 °C (-22 °F – +176 °F) |
| Colours | grey (RAL 7031), black (RAL 9005) |

- // raw material according to UL 94
- // locknut optional
- // easy disassembly without tools

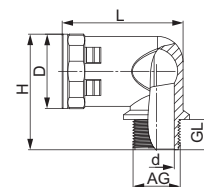

| AG | d mm | D mm | GL mm | H mm | L mm | fits to Polyamide- Conduit DN | Number grey | Number black |
|---------|---------|---------|----------|---------|---------|----------------------------------|----------------|-----------------|
| M 12 | 8,2 | 18,7 | 11 | 36,3 | 35,7 | 6 | 1.535.1200.50 | 1.535.1201.50 |
| M 16 | 10,8 | 21,7 | 11 | 37,3 | 38,5 | 10 | 1.535.1600.51 | 1.535.1601.51 |
| M 16 | 10,9 | 26 | 11 | 41 | 43,8 | 12 | 1.535.1600.50 | 1.535.1601.50 |
| M 20 | 14,7 | 28 | 11 | 44 | 46 | 14 | 1.535.2000.51 | 1.535.2001.51 |
| M 20 | 15,2 | 32 | 13 | 51,5 | 51 | 17 | 1.535.2000.50 | 1.535.2001.50 |
| M 25 | 18,7 | 39,5 | 16 | 61,2 | 64,3 | 23 | 1.535.2500.50 | 1.535.2501.50 |
| PG 7 | 8,2 | 18,7 | 11 | 36,3 | 35,7 | 6 | 1.535.0700.14 | 1.535.0701.14 |
| PG 9 | 10,3 | 21,7 | 11 | 37,3 | 38,5 | 10 | 1.535.0900.14 | 1.535.0901.14 |
| PG 11 | 13,3 | 26 | 11 | 41 | 43,8 | 12 | 1.535.1100.14 | 1.535.1101.14 |
| PG 13,5 | 15,3 | 28 | 11 | 44 | 46 | 14 | 1.535.1300.14 | 1.535.1301.14 |
| PG 16 | 16,6 | 32 | 13 | 51,5 | 51 | 17 | 1.535.1600.14 | 1.535.1601.14 |
| PG 21 | 22,4 | 39,5 | 16 | 61,2 | 64,3 | 23 | 1.535.2100.14 | 1.535.2101.14 |

Polyamide-Fitting Clip



| | |
|-----------------------|------------------------------------|
| Material | Polyamide |
| Operating Temperature | -30 °C – +80 °C (-22 °F – +176 °F) |
| Colours | black (RAL 9005) |

RoHS

// raw material according to UL 94

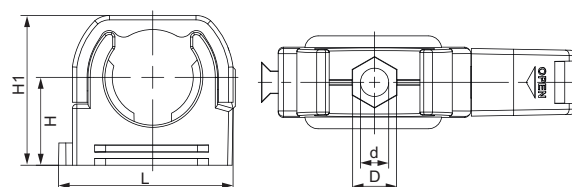

| Size DN | d mm | D mm | L mm | H mm | H1 mm | fits to Polyamide- Conduit DN | Number black |
|------------|---------|---------|---------|---------|----------|----------------------------------|-----------------|
| DN10 | 5 | 7 | 28,7 | 15,75 | 27,5 | 10 | 1.534.0901.00 |
| DN12 | 5,3 | 8,3 | 29,8 | 13,1 | 24 | 12 | 1.534.1101.00 |
| DN14 | 5,3 | 8,5 | 35,2 | 17,75 | 29,3 | 14 | 1.534.1401.00 |
| DN17 | 5,3 | 8,5 | 40,2 | 19,75 | 33,2 | 17 | 1.534.1601.00 |
| DN23 | 5,3 | 8,7 | 52,6 | 23,5 | 40,5 | 23 | 1.534.2101.00 |
| DN29 | 6,5 | 11 | 60,7 | 27 | 48 | 29 | 1.534.2901.00 |
| DN37 | 6,5 | 11 | 69 | 30,4 | 57 | 37 | 1.534.3601.00 |
| DN50 | 6,5 | 11 | 87 | 37,9 | 71 | 50 | 1.534.4801.00 |

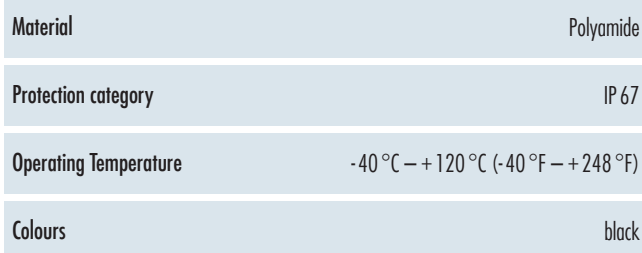

Polyamide-Fitting

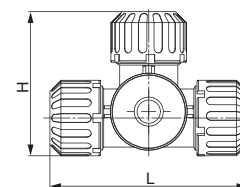

FITTINGS POLYAMIDE

Polyamide-Fitting Y



| | |
|-----------------------|-------------------------------------|
| Material | Polyamide |
| Protection category | IP 55 |
| Operating Temperature | -40 °C – +120 °C (-40 °F – +248 °F) |
| Colours | black |

// easy disassembly without tools

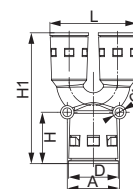

| Size DN | d mm | D mm | A mm | H mm | H1 mm | L mm | fits to Polyamide- Conduit DN | Number black |
|------------|---------|---------|---------|---------|----------|---------|----------------------------------|-----------------|
| DN12/10/10 | 5,5 | 22,3 | 25 | 31 | 74 | 42 | 12/10/10 | 1.537.1101.00 |
| DN17/12/12 | 6,5 | 28 | 32 | 32 | 85 | 51 | 17/12/12 | 1.537.1601.00 |
| DN23/17/17 | 6,5 | 36,4 | 38 | 38 | 90,5 | 63,8 | 23/17/17 | 1.537.2101.00 |
| DN29/23/23 | 6,5 | 43 | 45 | 37 | 106 | 76,8 | 29/23/23 | 1.537.2901.00 |

Polyamide-Fitting N

Metr., PG, NPT



| | |
|-----------------------|--|
| Material | Polyamide |
| Protection category | IP 54 with O-Ring with fixed conduit mounting IP 65 |
| Operating Temperature | -20 °C — +80 °C (-4 °F — +176 °F) |
| Colours | grey (RAL 7031), black (RAL 9005) |



// protection against unintended disconnect. Use screwdriver to disassemble

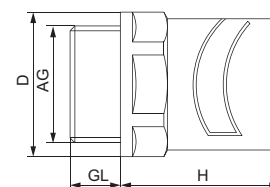

| AG | D mm | GL mm | H mm |  mm | fits to Polyamide- Conduit DN | Number grey | Number black |
|------------|---------|----------|---------|---|----------------------------------|----------------|-----------------|
| M 16 x 1,5 | 20 | 8 | 23 | 17 | 10 | 1.511.1600.50 | 1.511.1601.50 |
| M 20 x 1,5 | 26,5 | 9 | 28 | 24 | 14 | 1.511.2000.50 | 1.511.2001.50 |
| M 25 x 1,5 | 38,5 | 11 | 32 | 35 | 23 | 1.511.2500.50 | 1.511.2501.50 |
| M 32 x 1,5 | 46 | 11 | 35 | 42 | 29 | 1.511.3200.50 | 1.511.3201.50 |
| PG 9 | 19 | 8 | 23 | 17 | 10 | 1.511.0900.14 | 1.511.0901.14 |
| PG 11 | 23 | 8 | 25 | 21 | 12 | 1.511.1100.14 | 1.511.1101.14 |
| PG 13,5 | 26,5 | 9 | 28 | 24 | 14 | 1.511.1300.14 | 1.511.1301.14 |
| PG 16 | 30 | 10 | 29 | 27 | 17 | 1.511.1600.14 | 1.511.1601.14 |
| PG 21 | 38,5 | 11 | 32 | 35 | 23 | 1.511.2100.14 | 1.511.2101.14 |
| PG 29 | 46 | 11 | 35 | 42 | 29 | 1.511.2900.14 | 1.511.2901.14 |
| PG 36 | 54,5 | 13 | 41 | 50 | 37 | 1.511.3600.14 | 1.511.3601.14 |
| PG 48 | 70 | 14 | 46 | 64 | 50 | 1.511.4800.14 | 1.511.4801.14 |
| NPT 3/8" | 19 | 15 | 23 | 17 | 10 | 1.511.3800.70 | 1.511.3801.70 |
| NPT 1/2" | 30 | 13 | 29 | 27 | 17 | 1.511.1216.70 | 1.511.1217.70 |
| NPT 3/4" | 38,5 | 13 | 32 | 35 | 23 | 1.511.3400.70 | 1.511.3401.70 |
| NPT 1" | 46 | 15 | 35 | 42 | 29 | 1.511.1000.70 | 1.511.1001.70 |

Polyamide-Conduit

Polyamide-Fitting

Metal-Conduit / Metal-Fitting

Metal-Conduit Pro / Metal-Fitting Pro



| | |
|-----------------------|--|
| Material | Polyamide |
| O-Ring | NBR |
| Protection category | IP 54 with fixed conduit mounting IP 65 |
| Operating Temperature | -20 °C – +80 °C (-4 °F – +176 °F) |
| Colours | black (RAL 9005) |



// protection against unintended disconnect. Use screwdriver to disassemble

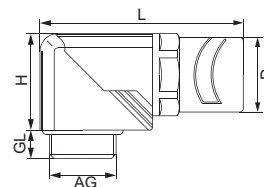

| AG | D mm | GL mm | H mm | L mm |  mm | fits to Polyamide- Conduit DN | Number |
|------------|---------|----------|---------|---------|--|----------------------------------|---------------|
| M 16 x 1,5 | 20 | 8 | 23 | 43 | 19 | 10 | 1.513.1601.50 |
| M 20 x 1,5 | 26,5 | 9 | 30,5 | 52 | 24 | 14 | 1.513.2001.50 |
| M 25 x 1,5 | 38,5 | 11 | 40 | 70 | 33 | 23 | 1.513.2501.50 |
| M 32 x 1,5 | 46 | 11 | 51,5 | 83 | 42 | 29 | 1.513.3201.50 |
| PG 9 | 19 | 8 | 23 | 43 | 19 | 10 | 1.513.0901.14 |
| PG 11 | 23 | 8 | 27 | 48 | 22 | 12 | 1.513.1101.14 |
| PG 13,5 | 26,5 | 9 | 30,5 | 52 | 24 | 14 | 1.513.1301.14 |
| PG 16 | 30 | 10 | 32,5 | 56 | 27 | 17 | 1.513.1601.14 |
| PG 21 | 38,5 | 11 | 40 | 70 | 33 | 23 | 1.513.2101.14 |
| PG 29 | 46 | 11 | 51,5 | 83 | 42 | 29 | 1.513.2901.14 |
| NPT 3/8" | 19 | 15 | 23 | 43 | 19 | 10 | 1.513.3801.70 |
| NPT 1/2" | 30 | 13 | 32,5 | 56 | 27 | 17 | 1.513.1217.70 |
| NPT 3/4" | 38,5 | 13 | 40 | 70 | 33 | 23 | 1.513.3401.70 |
| NPT 1" | 46 | 15 | 51,5 | 83 | 42 | 29 | 1.513.1001.70 |

Polyamide-Fitting DUO-Ms

Metr., PG



| | |
|-----------------------|---|
| Material | Nickel plated brass |
| Clamping insert | Polyamide |
| Seal | NBR |
| Protection category | IP 68 – 10 bar / IP 69K (NEMA 6 – 150 PSIG) on the cable gland |
| Operating Temperature | -40 °C – +100 °C (-40 °F – +212 °F) |



- // 2 in 1 cable gland and conduit fitting
- // easy disassembly without tools

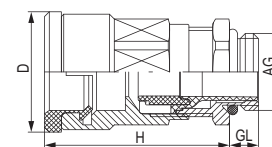

| AG | \varnothing mm | GL mm | H mm | D mm |  mm | fits to Polyamide- Conduit DN | Number |
|---------|---------------------|----------|---------|---------|--|----------------------------------|---------------|
| M 16 | 05–10 | 6 | 36 | 23 | 20/20 | 10 | 1.547.1610.50 |
| M 16 | 03–07 | 6 | 36 | 23 | 20/20 | 10 | 1.547.1610.51 |
| M 20 | 10–14 | 6 | 39,5 | 25 | 24/22 | 12 | 1.547.2012.50 |
| M 20 | 07–12 | 6 | 39,5 | 25 | 24/22 | 12 | 1.547.2012.51 |
| M 20 | 10–14 | 6 | 40,5 | 29 | 28/24 | 14 | 1.547.2014.50 |
| M 20 | 07–12 | 6 | 40,5 | 29 | 28/24 | 14 | 1.547.2014.51 |
| M 25 | 13–18 | 7 | 44,5 | 30 | 30/30 | 17 | 1.547.2517.50 |
| M 25 | 09–16 | 7 | 44,5 | 30 | 30/30 | 17 | 1.547.2517.51 |
| M 32 | 18–24 | 8 | 50,5 | 39 | 40/40 | 23 | 1.547.3223.50 |
| M 32 | 13–20 | 8 | 50,5 | 39 | 40/40 | 23 | 1.547.3223.51 |
| M 40 | 22–31 | 8 | 56,5 | 45 | 50/50 | 29 | 1.547.4029.50 |
| M 40 | 20–26 | 8 | 56,5 | 45 | 50/50 | 29 | 1.547.4029.51 |
| M 50 | 32–36 | 9 | 57,5 | 52 | 57/57 | 37 | 1.547.5037.50 |
| M 50 | 25–31 | 9 | 57,5 | 52 | 57/57 | 37 | 1.547.5037.51 |
| M 63 | 37–44 | 10 | 60,5 | 52 | 68/64 | 50 | 1.547.6350.50 |
| M 63 | 29–35 | 10 | 60,5 | 52 | 68/64 | 50 | 1.547.6350.51 |
| | | | | | | | |
| PG 11 | 05–10 | 6 | 36 | 23 | 20/20 | 10 | 1.548.1110.01 |
| PG 11 | 03–07 | 6 | 36 | 23 | 20/20 | 10 | 1.548.1110.15 |
| PG 13,5 | 6–12 | 6,5 | 39,5 | 25 | 24/22 | 12 | 1.548.1312.01 |
| PG 13,5 | 5–9 | 6,5 | 39,5 | 25 | 24/22 | 12 | 1.548.1312.15 |
| PG 16 | 10–14 | 6,5 | 40,5 | 29 | 28/24 | 14 | 1.548.1614.01 |
| PG 16 | 07–12 | 6,5 | 40,5 | 29 | 28/24 | 14 | 1.548.1614.15 |
| PG 21 | 13–16 | 7 | 44,5 | 30 | 30/30 | 17 | 1.548.2117.01 |
| PG 21 | 09–16 | 7 | 44,5 | 30 | 30/30 | 17 | 1.548.2117.15 |
| PG 29 | 18–22 | 8 | 50,5 | 39 | 40/40 | 23 | 1.548.2923.01 |
| PG 29 | 13–20 | 8 | 50,5 | 39 | 40/40 | 23 | 1.548.2923.15 |
| PG 36 | 22–28 | 8 | 56,5 | 45 | 50/50 | 29 | 1.548.3629.01 |
| PG 36 | 20–26 | 8 | 56,5 | 45 | 50/50 | 29 | 1.548.3629.15 |
| PG 42 | 32–36 | 9 | 57,5 | 52 | 57/57 | 37 | 1.548.4237.01 |
| PG 42 | 25–31 | 9 | 57,5 | 52 | 57/57 | 37 | 1.548.4237.15 |
| PG 48 | 37–44 | 10 | 60,5 | 52 | 64/64 | 50 | 1.548.4850.01 |
| PG 48 | 29–35 | 10 | 60,5 | 52 | 64/64 | 50 | 1.548.4850.15 |

FITTINGS POLYAMIDE

Polyamide-Fitting DUO-MS

NPT



| | |
|-----------------------|---|
| Material | Nickel plated brass |
| Clamping insert | Polyamide |
| Seal | NBR |
| Protection category | IP 68 – 10 bar / IP 69K (NEMA 6 – 150 PSIG) on the cable gland |
| Operating Temperature | -40 °C – +100 °C (-40 °F – +212 °F) |

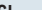
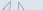

- // 2 in 1 cable gland and conduit fitting
- // easy disassembly without tools

| AG |  mm | GL mm | H mm | D mm |  mm | fits to Polyamide- Conduit DN | Number |
|----------|---|----------|---------|---------|---|----------------------------------|---------------|
| NPT 1/2" | 10–14 | 13 | 40,5 | 29 | 28/24 | 14 | 1.547.1214.70 |
| NPT 1/2" | 07–12 | 13 | 40,5 | 29 | 28/22 | 14 | 1.547.1214.71 |
| NPT 3/4" | 13–18 | 13 | 44.5 | 30 | 30/30 | 17 | 1.547.3417.70 |
| NPT 3/4" | 09–16 | 13 | 44.5 | 30 | 30/30 | 17 | 1.547.3417.71 |
| NPT 1" | 18–24 | 19 | 50,5 | 39 | 40/40 | 23 | 1.547.1023.70 |
| NPT 1" | 13–20 | 19 | 50.5 | 39 | 40/40 | 23 | 1.547.1023.71 |

Polyamide-Fitting DUO-PA

Metr., PG



| | |
|-----------------------|---|
| Material | Polyamide |
| Seal | NBR |
| Protection category | IP 68 – 10 bar / IP 69K (NEMA 6 – 150 PSIG) on the cable gland |
| Operating Temperature | -40 °C – +100 °C (-40 °F – +212 °F) |
| Colours | black (RAL 9005) |



- // 2 in 1 cable gland and conduit fitting
- // easy disassembly without tools

| AG | Ø mm | GL mm | H mm | D mm | mm | fits to Polyamide- Conduit DN | Number |
|---------|---------|----------|---------|---------|----|----------------------------------|---------------|
| M 16 | 05–10 | 8 | 40 | 23 | 22 | 10 | 1.542.1610.50 |
| M 16 | 03–07 | 8 | 40 | 23 | 22 | 10 | 1.542.1610.51 |
| M 20 | 06–12 | 10 | 44 | 25 | 24 | 12 | 1.542.2012.50 |
| M 20 | 05–09 | 10 | 44 | 25 | 24 | 12 | 1.542.2012.51 |
| M 20 | 10–14 | 10 | 46 | 29 | 27 | 14 | 1.542.2014.50 |
| M 20 | 07–12 | 10 | 46 | 29 | 27 | 14 | 1.542.2014.51 |
| M 25 | 13–18 | 11 | 50 | 30 | 33 | 17 | 1.542.2517.50 |
| M 25 | 09–16 | 11 | 50 | 30 | 33 | 17 | 1.542.2517.51 |
| M 32 | 18–24 | 11 | 60 | 39 | 42 | 23 | 1.542.3223.50 |
| M 32 | 13–20 | 11 | 60 | 39 | 42 | 23 | 1.542.3223.51 |
| M 40 | 22–31 | 13 | 69 | 45 | 53 | 29 | 1.542.4029.50 |
| M 40 | 20–26 | 13 | 69 | 45 | 53 | 29 | 1.542.4029.51 |
| M 50 | 32–36 | 13 | 74 | 52 | 60 | 37 | 1.542.5037.50 |
| M 50 | 25–31 | 13 | 74 | 52 | 60 | 37 | 1.542.5037.51 |
| M 63 | 37–44 | 14 | 79 | 52 | 68 | 50 | 1.542.6350.50 |
| M 63 | 29–35 | 14 | 79 | 52 | 68 | 50 | 1.542.6350.51 |
| | | | | | | | |
| PG 11 | 05–10 | 8 | 40 | 23 | 22 | 10 | 1.543.1110.14 |
| PG 11 | 03–07 | 8 | 40 | 23 | 22 | 10 | 1.543.1110.15 |
| PG 13,5 | 06–12 | 9 | 44 | 25 | 24 | 12 | 1.543.1312.14 |
| PG 13,5 | 05–09 | 9 | 44 | 25 | 24 | 12 | 1.543.1312.15 |
| PG 16 | 10–14 | 10 | 47 | 29 | 27 | 14 | 1.543.1614.14 |
| PG 16 | 07–12 | 10 | 47 | 29 | 27 | 14 | 1.543.1614.15 |
| PG 21 | 13–16 | 11 | 50 | 30 | 33 | 17 | 1.543.2117.14 |
| PG 21 | 09–16 | 11 | 50 | 30 | 33 | 17 | 1.543.2117.15 |
| PG 29 | 18–22 | 11 | 60 | 39 | 42 | 23 | 1.543.2923.14 |
| PG 29 | 13–20 | 11 | 60 | 39 | 42 | 23 | 1.543.2923.15 |
| PG 36 | 22–31 | 13 | 69 | 45 | 53 | 29 | 1.543.3629.14 |
| PG 36 | 20–26 | 13 | 69 | 45 | 53 | 29 | 1.543.3629.15 |
| PG 42 | 32–36 | 13 | 74 | 52 | 60 | 37 | 1.543.4237.14 |
| PG 42 | 25–31 | 13 | 74 | 52 | 60 | 37 | 1.543.4237.15 |
| PG 48 | 37–44 | 14 | 79 | 52 | 68 | 50 | 1.543.6350.14 |
| PG 48 | 29–35 | 14 | 79 | 52 | 68 | 50 | 1.543.6350.15 |



| | |
|-----------------------|---|
| Material | Polyamide |
| Seal | NBR |
| Protection category | IP 68 – 10 bar / IP 69K (NEMA 6 – 150 PSIG) on the cable gland |
| Operating Temperature | -40 °C – +100 °C (-40 °F – +212 °F) |
| Colours | black (RAL 9005) |

// 2 in 1 cable gland and conduit fitting
// easy disassembly without tools

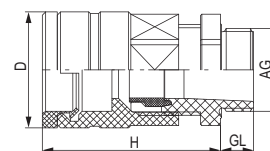

| AG | \varnothing mm | GL mm | H mm | D mm |  mm | fits to Polyamide- Conduit DN | Number |
|------------|---------------------|----------|---------|---------|---|----------------------------------|---------------|
| NPT 1/2" | 10–14 | 13 | 46 | 29 | 27 | 14 | 1.542.1214.70 |
| NPT 1/2" | 07–12 | 13 | 46 | 29 | 27 | 14 | 1.542.1214.71 |
| NPT 3/4" | 13–18 | 14 | 50 | 30 | 33 | 17 | 1.542.3417.70 |
| NPT 3/4" | 09–16 | 14 | 50 | 30 | 33 | 17 | 1.542.3417.71 |
| NPT 1" | 18–24 | 19 | 60 | 39 | 42 | 23 | 1.542.1023.70 |
| NPT 1" | 13–20 | 19 | 60 | 39 | 42 | 23 | 1.542.1023.71 |
| NPT 1 1/2" | 22–31 | 20 | 69 | 45 | 53 | 29 | 1.542.6429.70 |

R-M-PA

Metr., PG



| | |
|-----------------------|--|
| Material | Polyamide (Type A / Type B), Polypropylene (Type C) |
| Operating Temperature | -20 °C – +80 °C (-4 °F – +176 °F) |
| Colours | black (RAL 9005) |



RoHS

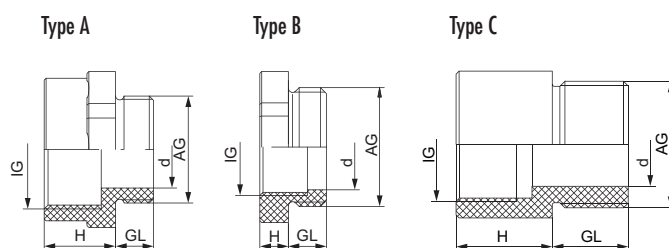

| AG | IG mm | Type | d mm | GL mm | H mm | mm | Number |
|------------|------------|------|---------|----------|---------|----|---------------|
| M 16 x 1,5 | M 12 x 1,5 | B | 10 | 8 | 6 | 20 | 1.273.1612.50 |
| M 20 x 1,5 | M 16 x 1,5 | B | 13,5 | 8 | 6 | 25 | 1.273.2016.50 |
| M 25 x 1,5 | M 20 x 1,5 | B | 18 | 8 | 6 | 29 | 1.273.2520.50 |
| M 32 x 1,5 | M 25 x 1,5 | B | 23 | 10 | 6 | 36 | 1.273.3225.50 |
| M 40 x 1,5 | M 32 x 1,5 | C | 30 | 15 | 5 | | 1.273.4032.50 |
| M 50 x 1,5 | M 40 x 1,5 | C | 38 | 15 | 5 | | 1.273.5040.50 |
| M 63 x 1,5 | M 50 x 1,5 | C | 48 | 15 | 5 | | 1.273.6350.50 |
| M 25 x 1,5 | PG 13,5 | B | 18 | 8 | 6 | 29 | 1.273.2513.50 |
| M 25 x 1,5 | PG 16 | A | 18 | 8 | 14 | 29 | 1.273.2516.50 |
| M 32 x 1,5 | PG 21 | A | 25 | 10 | 15 | 36 | 1.273.3221.50 |
| M 40 x 1,5 | PG 29 | A | 33 | 10 | 15 | 45 | 1.273.4029.50 |
| M 50 x 1,5 | PG 36 | A | 43 | 12 | 17 | 55 | 1.273.5036.50 |
| M 63 x 1,5 | PG 42 | C | 52 | 15 | 5 | | 1.273.6342.50 |
| PG 9 | M 12 x 1,5 | C | 15 | 19 | 8,5 | | 1.273.0912.11 |
| PG 11 | M 16 x 1,5 | C | 15 | 19 | 11,5 | | 1.273.1116.11 |
| PG 13,5 | M 16 x 1,5 | B | 25 | 8 | 6 | 14 | 1.273.1316.11 |
| PG 16 | M 20 x 1,5 | A | 27 | 8 | 13 | 16 | 1.273.1620.11 |
| PG 21 | M 25 x 1,5 | C | 15 | 19 | 20,5 | | 1.273.2125.11 |
| PG 29 | M 32 x 1,5 | C | 15 | 19 | 28 | | 1.273.2932.11 |
| PG 36 | M 40 x 1,5 | C | 15 | 5 | 38 | | 1.273.3640.11 |
| PG 42 | M 40 x 1,5 | C | 15 | 5 | 38 | | 1.273.4240.11 |
| PG 48 | M 50 x 1,5 | C | 15 | 5 | 38 | | 1.273.4850.11 |

Polyamide-Conduit

Polyamide-Fitting

Metal-Conduit / Metal-Fitting

Metal-Conduit Pro / Metal-Fitting Pro

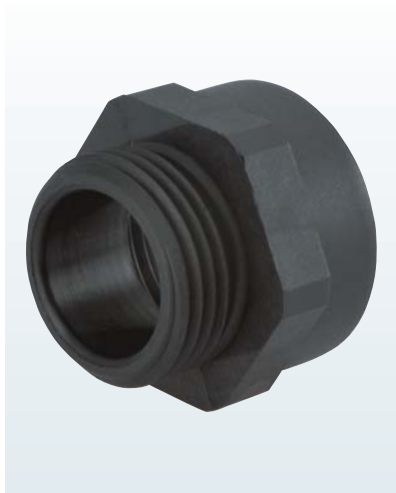

| | |
|-----------------------|--|
| Material | Polyamide (Type A / Type B), Polypropylene (Type C) |
| Operating Temperature | -20 °C — +80 °C (-4 °F — +176 °F) |
| Colours | K-FS grey (RAL 7035), E-M-PA black (RAL 9005) |

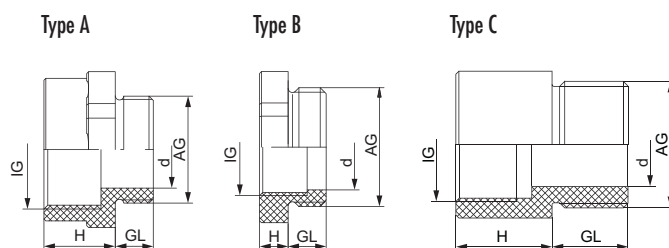

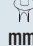
| AG | IG mm | Type | d mm | GL mm | H mm |  mm | Number |
|------------|------------|------|---------|----------|---------|---|---------------|
| M 12 x 1,5 | M 16 x 1,5 | A | 6,5 | 8 | 12 | 21 | 1.239.1216.50 |
| M 16 x 1,5 | M 20 x 1,5 | A | 9 | 8 | 13 | 25 | 1.239.1620.50 |
| M 20 x 1,5 | M 25 x 1,5 | A | 14 | 8 | 15 | 30 | 1.239.2025.50 |
| M 25 x 1,5 | M 32 x 1,5 | C | 16,5 | 15 | 15 | | 1.239.2532.50 |
| M 32 x 1,5 | M 40 x 1,5 | C | 23 | 15 | 19,5 | | 1.239.3240.50 |
| M 40 x 1,5 | M 50 x 1,5 | C | 30 | 15 | 19,5 | | 1.239.4050.50 |
| M 50 x 1,5 | M 63 x 1,5 | C | 39 | 15 | 20 | | 1.239.5063.50 |
| M 12 x 1,5 | PG 7 | A | 6,5 | 8 | 12 | 17 | 1.239.1207.50 |
| M 16 x 1,5 | PG 9 | C | 8,5 | 1 | 19 | | 1.239.1609.50 |
| M 20 x 1,5 | PG 13,5 | A | 14 | 8 | 13 | 25 | 1.239.2013.50 |
| M 63 x 1,5 | PG 48 | C | 51 | 15 | 20 | | 1.239.6348.50 |
| PG 7 | M 12 x 1,5 | C | 6 | 15 | 19 | | 1.239.0712.11 |
| PG 9 | M 16 x 1,5 | A | 9 | 8 | 12 | 21 | 1.239.0916.11 |
| PG 11 | M 20 x 1,5 | C | 11,5 | 15 | 19 | | 1.239.1120.11 |
| PG 13,5 | M 20 x 1,5 | A | 14 | 8 | 13 | 25 | 1.239.1320.11 |
| PG 16 | M 25 x 1,5 | A | 16 | 8 | 15 | 30 | 1.239.1625.11 |
| PG 21 | M 32 x 1,5 | A | 21 | 8 | 15 | 37 | 1.239.2132.11 |
| PG 29 | M 40 x 1,5 | A | 30 | 10 | 17 | 45 | 1.239.2940.11 |
| PG 36 | M 50 x 1,5 | C | 37 | 15 | 19,5 | | 1.239.3650.11 |
| PG 42 | M 50 x 1,5 | C | 43 | 15 | 19,5 | | 1.239.4250.11 |
| PG 48 | M 63 x 1,5 | C | 48 | 15 | 20 | | 1.239.4863.11 |
| PG 11 | PG 13,5 | B | 12,5 | 8 | 15 | 24 | 1.233.1113.11 |
| PG 13,5 | PG 16 | B | 15 | 9 | 16 | 27 | 1.233.1316.11 |
| PG 16 | PG 21 | B | 16 | 10 | 19 | 32 | 1.233.1621.11 |
| PG 21 | PG 29 | B | 22,5 | 11 | 21 | 42 | 1.233.2129.11 |

GM-FS

Metr., PG



| | |
|-----------------------|-------------------------------------|
| Material | Polyamide VO according to UL 94 |
| Operating Temperature | -40 °C – +100 °C (-40 °F – +212 °F) |
| Colours | grey (RAL 7035), black (RAL 9005) |

// other colours upon request

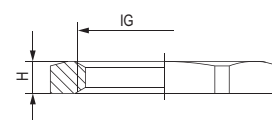

| IG | H mm | mm | Number PA VO grey | Number PA VO black |
|------------|---------|----|-------------------------|--------------------------|
| M 12 x 1,5 | 5 | 17 | 1.262.1200.50 | 1.262.1201.50 |
| M 16 x 1,5 | 5 | 22 | 1.262.1600.50 | 1.262.1601.50 |
| M 20 x 1,5 | 6 | 27 | 1.262.2000.50 | 1.262.2001.50 |
| M 25 x 1,5 | 6,5 | 32 | 1.262.2500.50 | 1.262.2501.50 |
| M 32 x 1,5 | 7 | 41 | 1.262.3200.50 | 1.262.3201.50 |
| M 40 x 1,5 | 7 | 50 | 1.262.4000.50 | 1.262.4001.50 |
| M 50 x 1,5 | 8 | 60 | 1.262.5000.50 | 1.262.5001.50 |
| M 63 x 1,5 | 8 | 75 | 1.262.6300.50 | 1.262.6301.50 |
| | | | | |
| PG 7 | 5 | 19 | 1.262.0700.11 | 1.262.0701.11 |
| PG 9 | 5 | 22 | 1.262.0900.11 | 1.262.0901.11 |
| PG 11 | 5 | 24 | 1.262.1100.11 | 1.262.1101.11 |
| PG 13,5 | 6 | 27 | 1.262.1300.11 | 1.262.1301.11 |
| PG 16 | 6 | 30 | 1.262.1600.11 | 1.262.1601.11 |
| PG 21 | 7 | 36 | 1.262.2100.11 | 1.262.2101.11 |
| PG 29 | 7 | 46 | 1.262.2900.11 | 1.262.2901.11 |
| PG 36 | 8 | 60 | 1.262.3600.11 | 1.262.3601.11 |
| PG 42 | 8 | 65 | 1.262.4200.11 | 1.262.4201.11 |
| PG 48 | 8 | 70 | 1.262.4800.11 | 1.262.4801.11 |
| | | | | |
| NPT 3/8" | 7 | 24 | 1.262.3800.70 | 1.262.3801.70 |
| NPT 1/2" | 6 | 27 | 1.262.1200.70 | 1.262.1201.70 |
| NPT 3/4" | 7 | 32 | 1.262.3400.70 | 1.262.3401.70 |
| NPT 1" | 7 | 40 | 1.262.1000.70 | 1.262.1001.70 |



METAL CABLE CONDUIT

Metal-Conduit A



| | |
|-----------------------|---------------------------------------|
| Material | galvanised steel |
| Protection category | IP 40 |
| Operating Temperature | -100 °C – +300 °C (-148 °F – +572 °F) |

RoHS

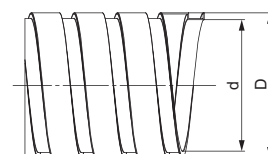

| Size DN | d mm | D mm |  | Number |
|------------|---------|---------|---|---------------|
| 7 | 7,5 | 10,5 | 25 | 1.560.0760.00 |
| 9 | 9 | 12 | 30 | 1.560.0960.00 |
| 11 | 11 | 14 | 30 | 1.560.1160.00 |
| 14 | 14 | 17 | 40 | 1.560.1460.00 |
| 16 | 16 | 19 | 45 | 1.560.1660.00 |
| 21 | 21 | 24 | 55 | 1.560.2160.00 |
| 26 | 26 | 30 | 55 | 1.560.2660.00 |
| 37 | 37 | 41 | 80 | 1.560.3760.00 |
| 40 | 40 | 44 | 80 | 1.560.4060.00 |
| 51 | 51 | 55 | 90 | 1.560.5160.00 |

RoHS



| | |
|-----------------------|-----------------------------------|
| Material | galvanised steel, PVC coating |
| Protection category | IP 65 |
| Operating Temperature | -15 °C – +70 °C (+5 °F – +158 °F) |

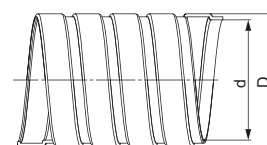

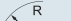
| Size DN | d mm | D mm |  | Number |
|------------|---------|---------|---|---------------|
| 7 | 7,5 | 11,5 | 25 | 1.561.0761.00 |
| 9 | 9 | 13 | 30 | 1.561.0961.00 |
| 11 | 11 | 15 | 30 | 1.561.1161.00 |
| 14 | 14 | 18 | 40 | 1.561.1461.00 |
| 16 | 16 | 20 | 45 | 1.561.1661.00 |
| 21 | 21 | 25 | 55 | 1.561.2161.00 |
| 26 | 26 | 31 | 55 | 1.561.2661.00 |
| 37 | 37 | 42 | 80 | 1.561.3761.00 |
| 40 | 40 | 45 | 80 | 1.561.4061.00 |
| 51 | 51 | 56 | 90 | 1.561.5161.00 |

Metal-Fitting



| | |
|-----------------------|-----------------------------------|
| Material | Nickel plated brass |
| Protection category | IP 54 |
| Operating Temperature | -20 °C — +80 °C (-4 °F — +176 °F) |

RoHS

// fixed mounted conduit fitting
// locknut optional

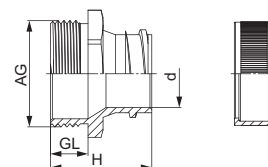



| AG | d mm | GL mm | H mm |  mm | fits to Metal- Conduit DN | Number |
|------------|---------|----------|---------|---|------------------------------|---------------|
| M 12 | 6 | 8 | 24 | 15 | 7 | 1.570.1260.50 |
| M 16 | 7 | 8 | 24 | 20 | 9 | 1.570.1660.51 |
| M 16 | 9 | 10 | 26 | 20 | 11 | 1.570.1660.50 |
| M 20 | 12 | 10 | 26 | 22 | 14 | 1.570.2060.51 |
| M 20 | 14 | 10 | 26 | 22 | 16 | 1.570.2060.50 |
| M 25 | 18 | 10 | 27 | 28 | 21 | 1.570.2560.50 |
| M 32 | 23 | 12 | 31 | 35 | 26 | 1.570.3260.50 |
| M 40 | 33,5 | 14 | 36 | 45 | 37 | 1.570.4060.50 |
| M 50 | 37 | 14 | 36 | 55 | 40 | 1.570.5060.50 |
| M 63 | 46 | 14 | 36 | 65 | 51 | 1.570.6360.50 |
| | | | | | | |
| PG 7 | 6 | 8 | 24 | 15 | 7 | 1.570.0760.14 |
| PG 9 | 7 | 8 | 24 | 17 | 9 | 1.570.0960.14 |
| PG 11 | 9 | 10 | 26 | 20 | 11 | 1.570.1160.14 |
| PG 13,5 | 12 | 10 | 26 | 22 | 14 | 1.570.1360.14 |
| PG 16 | 14 | 10 | 26 | 24 | 16 | 1.570.1660.14 |
| PG 21 | 18 | 10 | 27 | 30 | 21 | 1.570.2160.14 |
| PG 29 | 23 | 12 | 31 | 40 | 26 | 1.570.2960.14 |
| PG 36 | 33,5 | 14 | 36 | 50 | 37 | 1.570.3660.14 |
| PG 42 | 37 | 14 | 36 | 60 | 40 | 1.570.4260.14 |
| PG 48 | 46 | 14 | 36 | 65 | 51 | 1.570.4860.14 |
| | | | | | | |
| NPT 1/4" | 6 | 10 | 26 | 15 | 7 | 1.570.1460.70 |
| NPT 3/8" | 7 | 11,5 | 27,5 | 20 | 9 | 1.570.3860.71 |
| NPT 3/8" | 9 | 11,5 | 27,5 | 20 | 11 | 1.570.3860.70 |
| NPT 1/2" | 12 | 13 | 29 | 22 | 14 | 1.570.1260.71 |
| NPT 1/2" | 14 | 13 | 29 | 22 | 16 | 1.570.1260.70 |
| NPT 3/4" | 18 | 15 | 32 | 28 | 21 | 1.570.3460.70 |
| NPT 1" | 23 | 15 | 34 | 35 | 26 | 1.570.1060.70 |
| NPT 1 1/4" | 33,5 | 16 | 38 | 45 | 37 | 1.570.5460.70 |
| NPT 1 1/2" | 37 | 18 | 40 | 55 | 40 | 1.570.6460.70 |
| NPT 2" | 46 | 20 | 42 | 65 | 51 | 1.570.2060.70 |

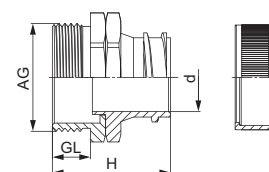

| | |
|-----------------------|-----------------------------------|
| Material | Nickel plated brass |
| Protection category | IP 54 |
| Operating Temperature | -20 °C — +80 °C (-4 °F — +176 °F) |

// swivel conduit fitting
// locknut optional



| AG | d mm | GL mm | H mm |  mm | fits to Metal- Conduit DN | Number |
|------------|---------|----------|---------|---|------------------------------|---------------|
| M 12 | 6 | 8 | 27 | 15 | 7 | 1.571.1260.50 |
| M 16 | 7 | 8 | 27 | 20 | 9 | 1.571.1660.51 |
| M 16 | 9 | 10 | 29 | 20 | 11 | 1.571.1660.50 |
| M 20 | 12 | 10 | 29 | 22 | 14 | 1.571.2060.51 |
| M 20 | 14 | 10 | 29 | 22 | 16 | 1.571.2060.50 |
| M 25 | 18 | 10 | 31 | 28 | 21 | 1.571.2560.50 |
| M 32 | 23 | 12 | 35 | 35 | 26 | 1.571.3260.50 |
| M 40 | 33,5 | 14 | 41 | 45 | 37 | 1.571.4060.50 |
| M 50 | 37 | 14 | 41 | 55 | 40 | 1.571.5060.50 |
| M 63 | 46 | 14 | 41 | 65 | 51 | 1.571.6360.50 |
| | | | | | | |
| PG 7 | 6 | 8 | 27 | 15 | 7 | 1.571.0760.14 |
| PG 9 | 7 | 8 | 27 | 17 | 9 | 1.571.0960.14 |
| PG 11 | 9 | 10 | 29 | 20 | 11 | 1.571.1160.14 |
| PG 13,5 | 12 | 10 | 29 | 22 | 14 | 1.571.1360.14 |
| PG 16 | 14 | 10 | 29 | 24 | 16 | 1.571.1660.14 |
| PG 21 | 18 | 10 | 31 | 30 | 21 | 1.571.2160.14 |
| PG 29 | 23 | 12 | 35 | 40 | 26 | 1.571.2960.14 |
| PG 36 | 33,5 | 14 | 41 | 50 | 37 | 1.571.3660.14 |
| PG 42 | 37 | 14 | 41 | 60 | 40 | 1.571.4260.14 |
| PG 48 | 46 | 14 | 41 | 65 | 51 | 1.571.4860.14 |
| | | | | | | |
| NPT 1/4" | 6 | 10 | 29 | 15 | 7 | 1.571.1460.70 |
| NPT 3/8" | 7 | 11,5 | 30,5 | 20 | 9 | 1.571.3860.71 |
| NPT 3/8" | 9 | 11,5 | 30,5 | 20 | 11 | 1.571.3860.70 |
| NPT 1/2" | 12 | 13 | 32 | 22 | 14 | 1.571.1260.71 |
| NPT 1/2" | 14 | 13 | 32 | 22 | 16 | 1.571.1260.70 |
| NPT 3/4" | 18 | 15 | 36 | 28 | 21 | 1.571.3460.70 |
| NPT 1" | 23 | 15 | 39 | 35 | 26 | 1.571.1060.70 |
| NPT 1 1/4" | 33,5 | 16 | 43 | 45 | 37 | 1.571.5460.70 |
| NPT 1 1/2" | 37 | 18 | 45 | 55 | 40 | 1.571.6460.70 |
| NPT 2" | 46 | 20 | 47 | 65 | 51 | 1.571.2060.70 |

METAL CABLE CONDUIT

Metal-Conduit Pro A



| | |
|-----------------------|------------------------------------|
| Material | galvanised steel, PVC coating |
| Protection category | IP 66 |
| Operating Temperature | -20 °C – +105 °C (-4 °F – +221 °F) |

RoHS

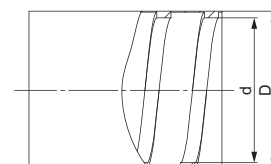

| Size DN | d mm | D mm |  R mm | Number |
|------------|---------|---------|--|---------------|
| 10 | 10,3 | 16 | 40 | 1.562.1061.00 |
| 12 | 12,3 | 18 | 45 | 1.562.1261.00 |
| 16 | 15,5 | 21 | 65 | 1.562.1661.00 |
| 21 | 20,9 | 26,5 | 100 | 1.562.2161.00 |
| 27 | 26,5 | 33,3 | 135 | 1.562.2761.00 |
| 35 | 35 | 42 | 175 | 1.562.3561.00 |
| 40 | 40 | 48,2 | 230 | 1.562.4061.00 |
| 51 | 51,5 | 60 | 280 | 1.562.5161.00 |



| | |
|-----------------------|---------------------------------------|
| Material | galvanised steel |
| Protection category | IP 40 |
| Operating Temperature | -100 °C – +300 °C (-148 °F – +572 °F) |

RoHS

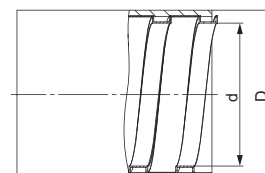

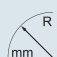
| Size DN | d mm | D mm |  R mm | Number |
|------------|---------|---------|--|---------------|
| 9 | 9 | 14 | 30 | 1.563.0960.00 |
| 11 | 11 | 16 | 35 | 1.563.1160.00 |
| 13 | 13 | 17,5 | 40 | 1.563.1360.00 |
| 16 | 16 | 21 | 45 | 1.563.1660.00 |
| 21 | 21 | 26 | 55 | 1.563.2160.00 |
| 26 | 26 | 32 | 70 | 1.563.2660.00 |
| 35 | 35 | 41 | 80 | 1.563.3560.00 |
| 40 | 40 | 46 | 90 | 1.563.4060.00 |
| 51 | 51 | 57 | 90 | 1.563.5160.00 |

Polyamide-Conduit

Polyamide-Fitting

Metal-Conduit / Metal-Fitting

Metal-Conduit Pro / Metal-Fitting Pro

METAL CABLE CONDUIT

Metal-Conduit Pro C



| | |
|-----------------------|-----------------------------------|
| Material | galvanised steel |
| Protection category | IP 65 |
| Operating Temperature | -15 °C – +70 °C (+5 °F – +158 °F) |

RoHS

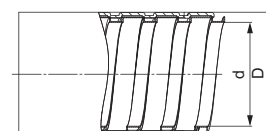

| Size DN | d mm | D mm |  mm | Number |
|------------|---------|---------|---|---------------|
| 9 | 9 | 15 | 30 | 1.564.0960.00 |
| 11 | 11 | 17 | 35 | 1.564.1160.00 |
| 13 | 13 | 18,5 | 40 | 1.564.1360.00 |
| 16 | 16 | 22 | 45 | 1.564.1660.00 |
| 21 | 21 | 27 | 55 | 1.564.2160.00 |
| 26 | 26 | 33 | 70 | 1.564.2660.00 |
| 35 | 35 | 42 | 80 | 1.564.3560.00 |
| 40 | 40 | 47 | 90 | 1.564.4060.00 |
| 51 | 51 | 58 | 90 | 1.564.5160.00 |

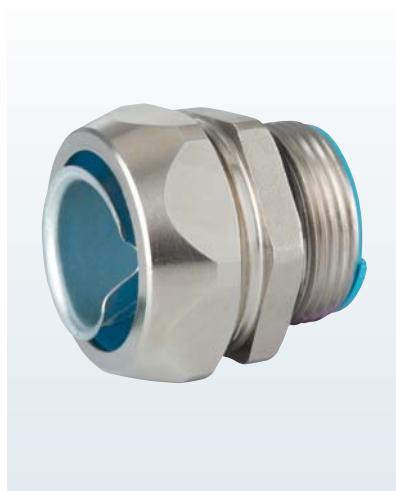

| | |
|-----------------------|-----------------------------------|
| Material | Nickel plated brass |
| Protection category | IP 67 |
| Operating Temperature | -20 °C — +80 °C (-4 °F — +176 °F) |

// fixed mounted conduit fitting
// locknut optional

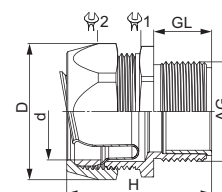

| AG | d mm | D mm | GL mm | H mm | 1 mm | 2 mm | fits to Polyamid- Conduit Pro DN | Number |
|------------|---------|---------|----------|---------|---------|---------|-------------------------------------|---------------|
| M 12 | 16,5 | 24,5 | 10 | 31 | 20 | 22 | -/09 | 1.572.1260.50 |
| M 16 | 19 | 29,2 | 10 | 35 | 24 | 26 | 11/12 | 1.572.1660.51 |
| M 16 | 22 | 32,6 | 11,5 | 39 | 27 | 29 | 12/13 | 1.572.1660.50 |
| M 20 | 22 | 32,6 | 13 | 38,7 | 27 | 29 | 16 | 1.572.2060.50 |
| M 25 | 27,5 | 38,8 | 15 | 41 | 33 | 35 | 21 | 1.572.2560.50 |
| M 32 | 34,5 | 50 | 15 | 49 | 43 | 45 | 26/27 | 1.572.3260.50 |
| M 40 | 43,5 | 60 | 16 | 51 | 52 | 54 | 35 | 1.572.4060.50 |
| M 50 | 49,5 | 69,3 | 18 | 61 | 60 | 63 | 40 | 1.572.5060.50 |
| M 63 | 62 | 85 | 20 | 73 | 74 | 77 | 51 | 1.572.6360.50 |
| | | | | | | | | |
| PG 7 | 16,5 | 24,5 | 10 | 31 | 20 | 22 | -/09 | 1.572.0760.14 |
| PG 9 | 16,5 | 24,5 | 10 | 31 | 20 | 22 | 11/12 | 1.572.0960.14 |
| PG 11 | 19 | 29,2 | 11,5 | 35 | 24 | 26 | 12/13 | 1.572.1160.14 |
| PG 13,5 | 22 | 32,6 | 13 | 39 | 27 | 29 | 16 | 1.572.1360.14 |
| PG 16 | 22 | 32,6 | 13 | 38,7 | 27 | 29 | 16 | 1.572.1660.14 |
| PG 21 | 27,5 | 38,8 | 15 | 41 | 33 | 35 | 21 | 1.572.2160.14 |
| PG 29 | 34,5 | 50 | 15 | 49 | 43 | 45 | 26/27 | 1.572.2960.14 |
| PG 36 | 43,5 | 60 | 16 | 51 | 52 | 54 | 35 | 1.572.3660.14 |
| PG 42 | 49,5 | 69,3 | 18 | 61 | 60 | 63 | 40 | 1.572.4260.14 |
| PG 48 | 62 | 85 | 20 | 73 | 74 | 77 | 51 | 1.572.4860.14 |
| | | | | | | | | |
| NPT 1/4" | 16,5 | 24,5 | 10 | 31 | 20 | 22 | 10/11 | 1.572.1460.70 |
| NPT 3/8" | 19 | 29,2 | 11,5 | 35 | 20 | 22 | 12/13 | 1.572.3860.70 |
| NPT 1/2" | 22 | 32,6 | 13 | 38,7 | 27 | 29 | 16 | 1.572.1260.70 |
| NPT 3/4" | 27,5 | 38,8 | 15 | 41 | 33 | 35 | 21 | 1.572.3460.70 |
| NPT 1" | 34,5 | 50 | 15 | 49 | 43 | 45 | 27/26 | 1.572.1060.70 |
| NPT 1 1/4" | 43,5 | 60 | 16 | 51 | 52 | 54 | 35 | 1.572.5460.70 |
| NPT 1 1/2" | 49,5 | 69,3 | 18 | 61 | 60 | 63 | 40 | 1.572.6460.70 |
| NPT 2" | 62 | 85 | 20 | 73 | 74 | 77 | 51 | 1.572.2060.70 |

Metal-Fitting Pro S



| | |
|-----------------------|-----------------------------------|
| Material | Nickel plated brass |
| Protection category | IP 67 |
| Operating Temperature | -20 °C — +80 °C (-4 °F — +176 °F) |

RoHS

// swivel conduit fitting
// locknut optional

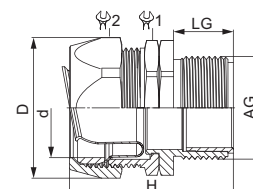

| AG | d mm | D mm | GL mm | H mm | 1 mm | 2 mm | fits to Polyamid- Conduit Pro DN | Number |
|------------|---------|---------|----------|---------|---------|---------|-------------------------------------|---------------|
| M 12 | 16,5 | 24,5 | 10 | 34 | 20 | 22 | -/09 | 1.573.1260.50 |
| M 16 | 16,5 | 24,5 | 10 | 35 | 20 | 22 | 10/11 | 1.573.1660.51 |
| M 16 | 19 | 29,2 | 10 | 37 | 20 | 22 | 12/13 | 1.573.1660.50 |
| M 20 | 22 | 32,6 | 13 | 41 | 27 | 29 | 16 | 1.573.2060.50 |
| M 25 | 27,5 | 38,8 | 15 | 44 | 33 | 35 | 21 | 1.573.2560.50 |
| M 32 | 34,5 | 50 | 15 | 51 | 43 | 45 | 27/26 | 1.573.3260.50 |
| M 40 | 43,5 | 60 | 16 | 54 | 52 | 54 | 35 | 1.573.4060.50 |
| M 50 | 49,5 | 69,3 | 18 | 64 | 60 | 63 | 40 | 1.573.5060.50 |
| M 63 | 62 | 85 | 20 | 76 | 74 | 77 | 51 | 1.573.6360.50 |
| | | | | | | | | |
| PG 7 | 16,5 | 24,5 | 10 | 34 | 20 | 22 | -/09 | 1.573.0760.14 |
| PG 9 | 16,5 | 24,5 | 10 | 34 | 20 | 22 | 10/11 | 1.573.0960.14 |
| PG 11 | 19 | 29,2 | 11,5 | 35 | 24 | 26 | 12/13 | 1.573.1160.14 |
| PG 13,5 | 22 | 32,6 | 13 | 37 | 27 | 29 | 16 | 1.573.1360.14 |
| PG 16 | 22 | 32,6 | 13 | 41 | 27 | 29 | 16 | 1.573.1660.14 |
| PG 21 | 27,5 | 38,8 | 15 | 44 | 33 | 35 | 21 | 1.573.2160.14 |
| PG 29 | 34,5 | 50 | 15 | 51 | 43 | 45 | 27/26 | 1.573.2960.14 |
| PG 36 | 43,5 | 60 | 16 | 54 | 52 | 54 | 35 | 1.573.3660.14 |
| PG 42 | 49,5 | 69,3 | 18 | 64 | 60 | 63 | 40 | 1.573.4260.14 |
| PG 48 | 62 | 85 | 20 | 76 | 74 | 77 | 51 | 1.573.4860.14 |
| | | | | | | | | |
| NPT 1/4" | 16,5 | 24,5 | 10 | 35 | 20 | 22 | 10/11 | 1.573.1460.70 |
| NPT 3/8" | 19 | 29,2 | 11,5 | 37 | 20 | 22 | 12/13 | 1.573.3860.70 |
| NPT 1/2" | 22 | 32,6 | 13 | 41 | 27 | 29 | 16 | 1.573.1260.70 |
| NPT 3/4" | 27,5 | 38,8 | 15 | 44 | 33 | 35 | 21 | 1.573.3460.70 |
| NPT 1" | 34,5 | 50 | 15 | 51 | 43 | 45 | 26/27 | 1.573.1060.70 |
| NPT 1 1/4" | 43,5 | 60 | 16 | 54 | 52 | 54 | 35 | 1.573.5460.70 |
| NPT 1 1/2" | 49,5 | 69,3 | 18 | 64 | 60 | 63 | 40 | 1.573.6460.70 |
| NPT 2" | 62 | 85 | 20 | 76 | 74 | 77 | 51 | 1.573.2060.70 |

RoHS



Metal

Metal-Conduit Pro / Metal-Fitting Pro

ACCESSORIES METAL

GM-Ms

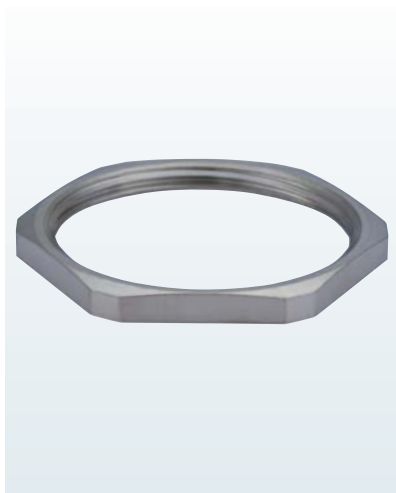

Material

Nickel plated brass

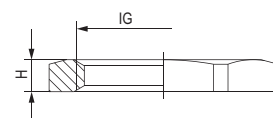
[illegible]

Numerical / Alphabetical index

| Product Number | Description | Page | Product Number | Description | Page | Product Number | Description | Page |
|----------------|------------------------------|------|----------------|-------------------------------------|------|----------------|---------------------------|------|
| 1.161 | GM-Ms | 30 | 1.535 | Polyamide-Fitting 90 | 7 | 1.562 | Metal-Conduit Pro A | 24 |
| 1.239 | E-M-PA, KFS | 18 | 1.536 | Polyamide-Fitting T | 9 | 1.563 | Metal-Conduit Pro B | 25 |
| 1.262 | GM-FS | 19 | 1.537 | Polyamide-Fitting Y | 10 | 1.564 | Metal-Conduit Pro C | 26 |
| 1.273 | R-M-PA | 17 | 1.542 | Polyamide-Fitting DUO-PA metr. | 15 | 1.574 | Metal-Fitting Clip | 29 |
| 1.503 | Polyamide Cut | 5 | 1.542 | Polyamide-Fitting DUO-PA metr. | 16 | 1.570 | Metal-Fitting | 22 |
| 1.510 | Polyamide-Conduit | 4 | 1.543 | Polyamide-Fitting DUO-PA PG | 15 | 1.571 | Metal-Fitting S | 23 |
| 1.511 | Polyamide-Fitting N | 11 | 1.547 | Polyamide-Fitting DUO-Ms metr. | 13 | 1.572 | Metal-Fitting Pro | 27 |
| 1.513 | Polyamide-Fitting W | 12 | 1.547 | Polyamide-Fitting DUO-Ms NPT | 14 | 1.573 | Metal-Fitting Pro S | 28 |
| 1.527 | Polyamide-Conduit Slit | 5 | 1.548 | Polyamide-Fitting DUO-Ms PG | 13 | | | |
| 1.533 | Polyamide-Fitting | 6 | 1.560 | Metal-Conduit A | 20 | | | |
| 1.534 | Polyamide-Fitting Clip | 8 | 1.561 | Metal-Conduit B | 21 | | | |

Limited Liability

Products, design, colours and dimensions are subject to change without prior notice. We reserve the right to make technical improvements on all our products, currently ordered or for future orders. It is the user's responsibility to verify all dimensions and technical data. HUMMEL AG will assume no liability regarding information provided to the user by published literature or inside technical staff, its distributors and outside sales personnel. Errors in the catalogue can occur and shall not create any liability whatsoever for HUMMEL. All information provided by HUMMEL is without guarantee and must be verified by the user.

Created & Printed by

Graphic & Layout:

HUMMEL AG, Marketing & Communications, Lise-Meitner-Str. 2, 79211 Denzlingen, Germany, Tel. +49 (0) 76 66 9 11 10-842, Fax +49 (0) 76 66 9 11 10-20, info@hummel.com

Printer:

Druckerei Furtwängler GmbH, 79211 Denzlingen, Germany, Tel. +49 (0) 76 66 / 13 31. Printed on recycled paper in April 2018.

ELECTRIC COMPONENTS

Cable Glands

Polyamide-, Brass- and Stainless steel,
EMC-connections, Ex e-, Ex d-, Ex ta-Cable Glands



Circular Connectors

M 8 to M 40, INOX, TWILOCK, Industrial Ethernet,
Power, Signal, Hybrid-Connector, Moulded Cordsets



Cable Protection Systems

Corrugated Conduit Systems, Conduit Cable Glands, Angled Systems,
combined Cable Glands, Accessories



Cable Assembly

Moulded Signal- and Power Circular Connectors,
Servo Cables, Cable Sets



www.hummel.com



HUMMEL AG
Lise-Meitner-Straße 2
79211 Denzlingen
Germany
www.hummel.com

Tel. +49 (0) 76 66 / 9 11 10-0
Fax +49 (0) 76 66 / 9 11 10-20
E-Mail info@hummel.com

